

**MAZARIN 55ft solar catamaran**

MAZARIN 55尺太阳能双体电动船

**Specifications**

DC混合动力版配置明细



**MAZARIN 55FT SOLAR CATAMARAN DC HYBIRD VERSION**

Standard Specifications 标准规范

Classification: CE

等级: CE

**Technical Data 技术参数**

Length overall 全长:	16.7m
Length of waterline 水线长度:	15.91 m
Beam 最大宽幅:	8.44 m
Draft 吃水深度:	0.65m
Bridgedeck height连接桥高度:	1.00 m
Height overall船高:	4.35m
Displacement light 空载排水量:	25 tons
Fuel capacity 燃料容量:	1300 ltrs
Fresh water capacity 淡水容量:	800 ltrs
Cruising speed巡航速度:	6-8kn
Max. speed最高航速:	10 kn

**推进系统 Pulpusion system**

2台*50KW电动机	品牌: Danfoss or similar	Electric motors: 2 x50KW
1台*50KW直流发电机	品牌: Danfoss or similar	Generator: 1X50KW DC
太阳能板10kwh	品牌: Link Solar	10KWH
锂电池组160KWH 400V	品牌: 宁德时代	160KWH Li-battery 400V



飞桥Flybridge

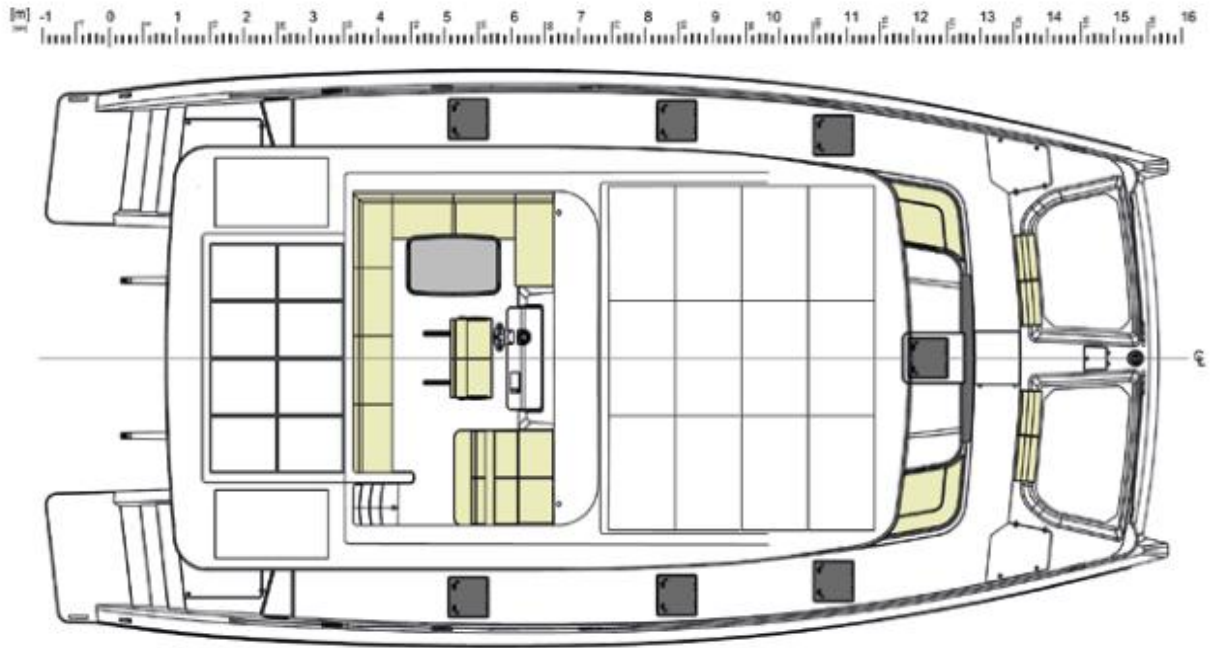

主甲板Main deck

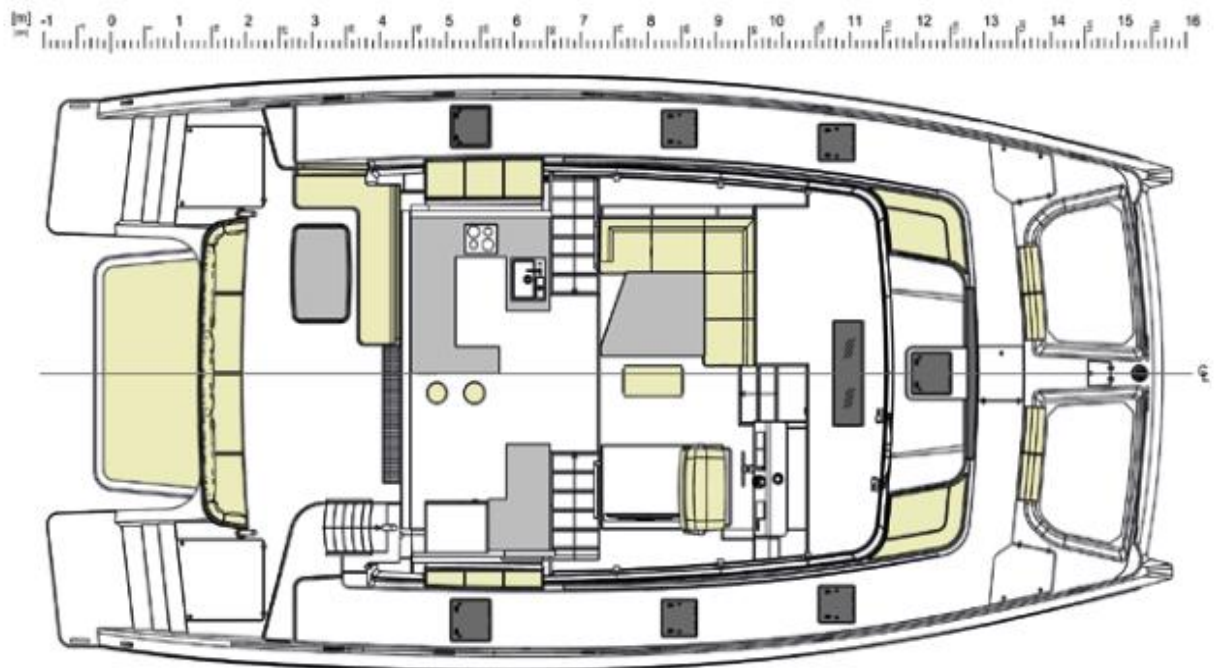

**Cabin layout**

下甲板舱室布置图

方案一：4舱+4卫（大空间主人房） 标配布局

Version 1: 4 cabins 4 bathrooms (front owner's room) Standard layout

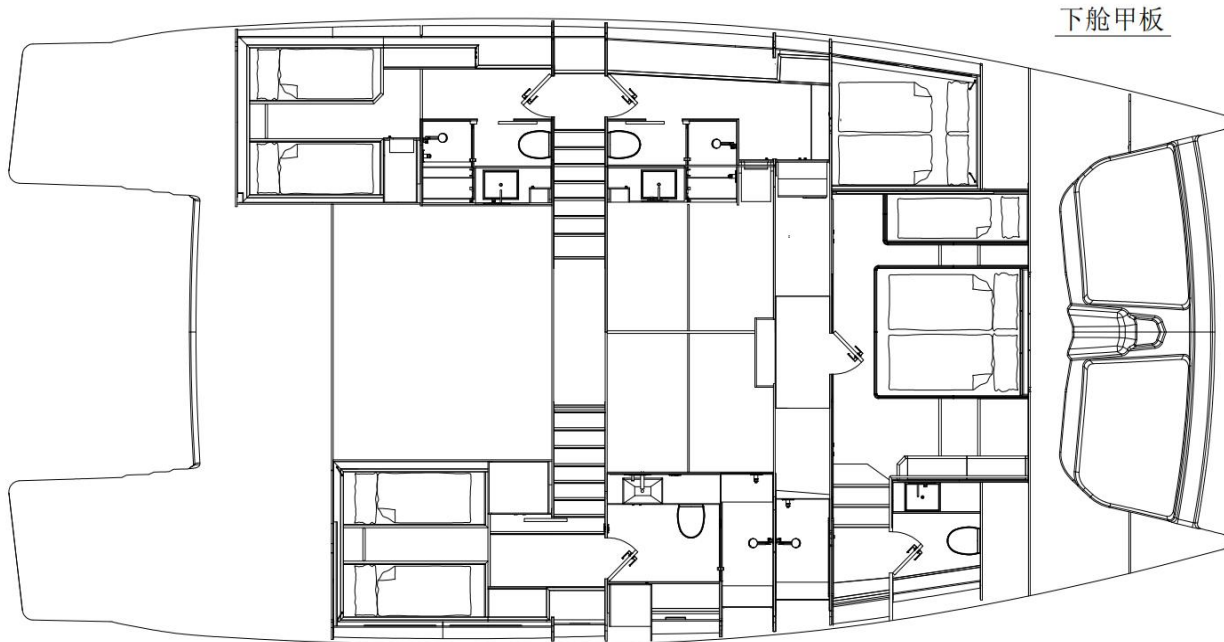

方案二：4舱+4卫，沙龙前开门（选配）

Version 2: 4 cabins 4 bathrooms, with front salon door (optional)

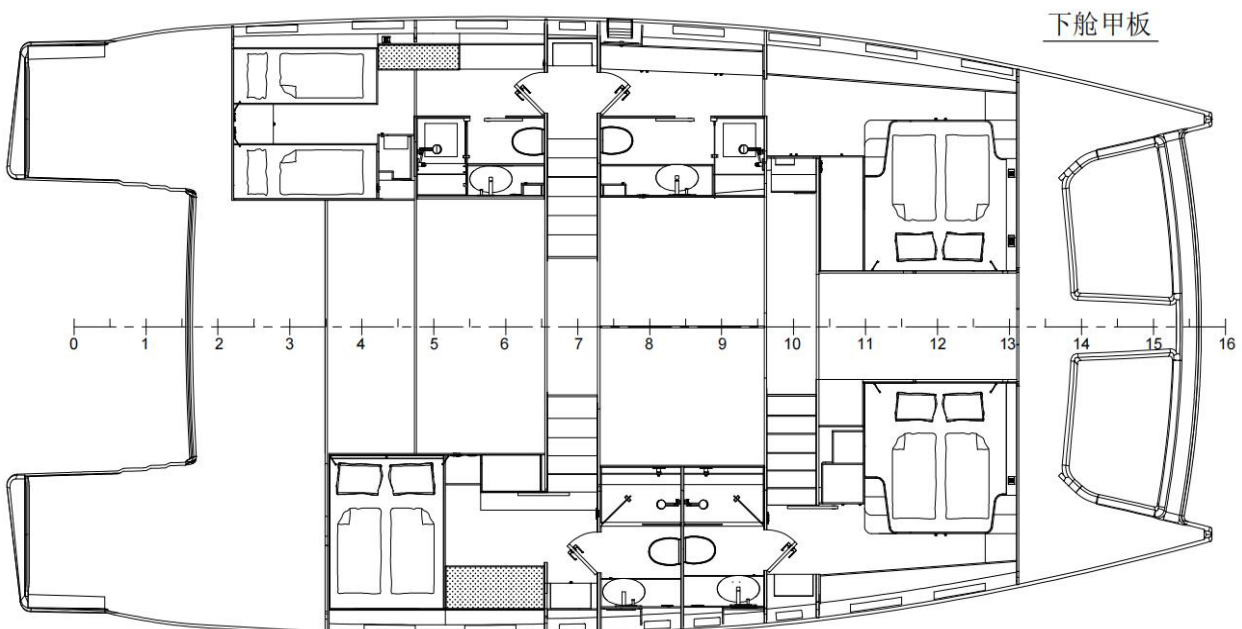



方案三：5舱+4卫，沙龙前开门（选配）

Version 3: 5 cabins 4 bathrooms with front salon door (optional)

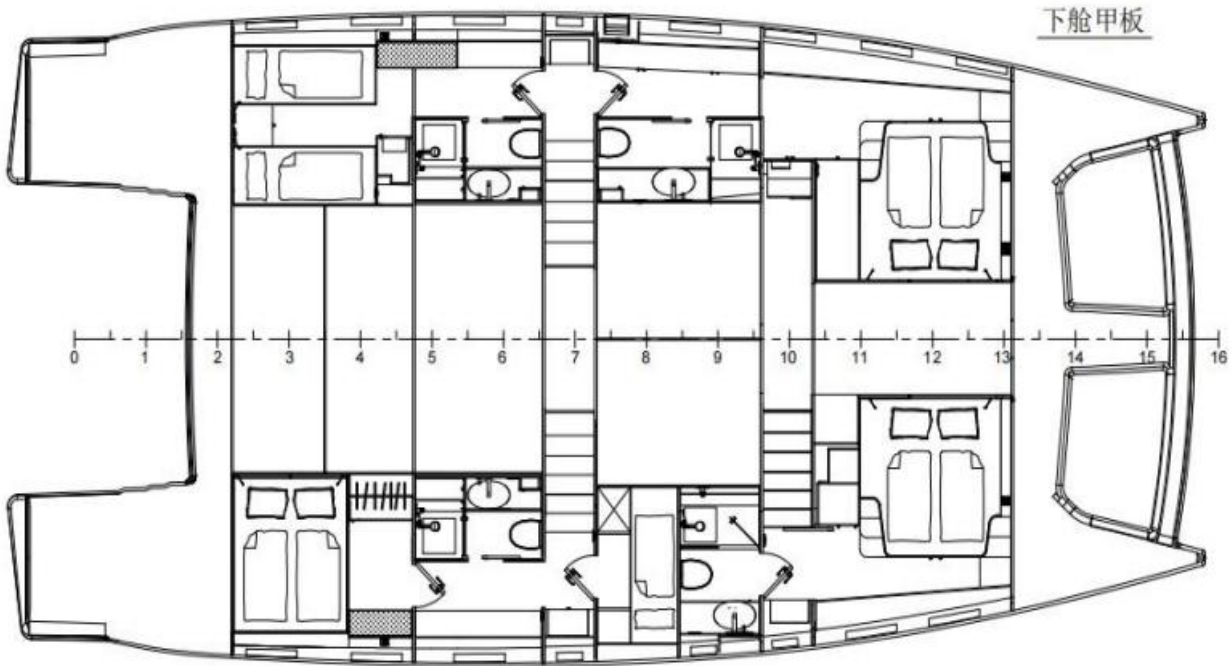

方案四：6舱+5卫，含水手房+洗手间（选配）

Version 4: 6 cabins 5 bathrooms including crew room (optional)

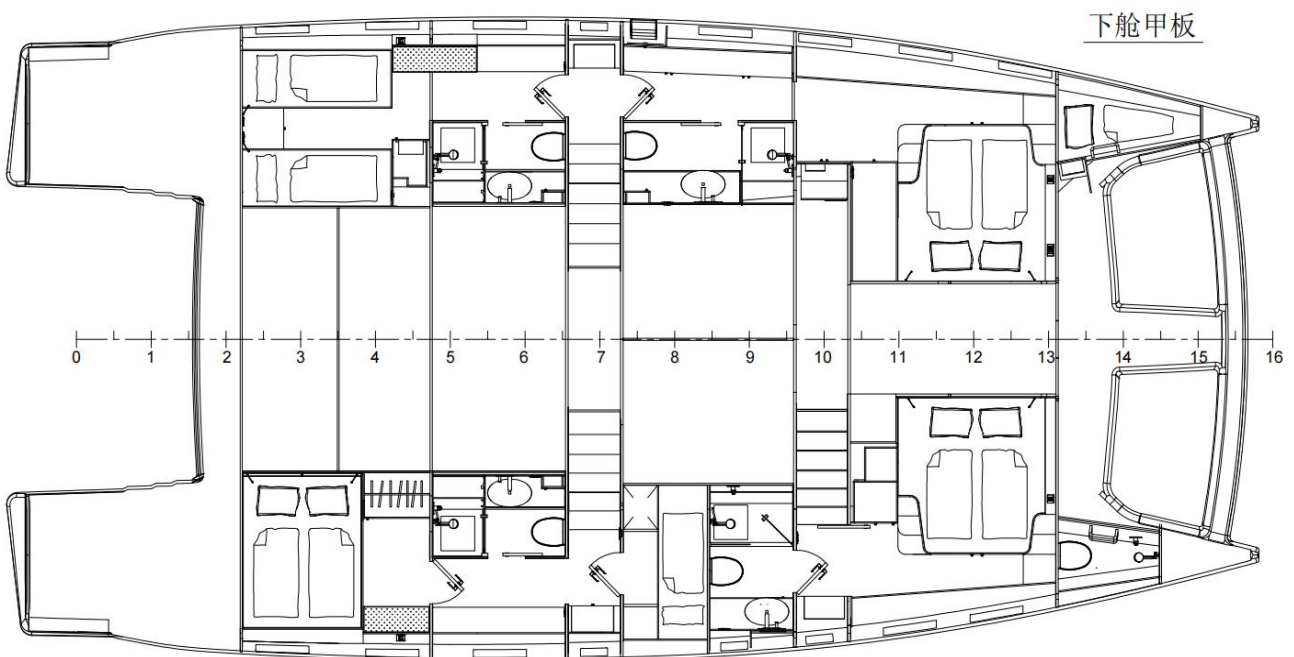

**MAZARIN 55FT SOLAR CATAMARAN 55尺太阳能双体船DC HYBIRD版**

Standard Specification 标准参数

<b>1. Construction 结构</b>			
1	真空吸附工艺制作玻璃钢	GRP by vacuum infusion	
2	高品质胶衣表面	Gel coat surface	
3	整体一次成型船底结构	Strengthening simplex hull bottom	
4	船体上部三明治夹心结构	Upper sandwich structure of the GRP hull	
5	上层飞桥三明治夹心结构	Sandwich structure of the GRP flybridge	
6	甲板和龙骨用碳纤维加强	Deck and keel were reinforced by carbon fiber	
7	超轻质玻纤/碳纤维三明治复合材料	Ultra light weight glass/carbon sandwich composite construction	
8	水线下环氧底漆及黑色防污面漆	Under waterline epoxy Primer and black anti-fouling paint	
<b>2. Flybridge 飞桥</b>			
9	后甲板上飞桥的楼梯	Access stairs to cockpit	
10	排水系统	Drainage system	
11	带储物格的L型玻璃钢沙发座	GRP " L " shape seats w/ lockers	
12	长沙发，布料为Sunbrella户外面料	Sun lounge with Sunbrella fabric	
13	白色玻璃钢面桌子 固定桌腿	GRP table	
14	不锈钢扶手	Stainless steel handrails	
15	监控摄像头安装于雷达支架	Camera on radar mast	飞桥后艄
16	导航灯5个	LED navigation lights*5	AQUA SIGNAL
17	喇叭位于飞桥后顶部	Air horn on aft top of flybridge	
18	船铭牌位于上建两侧	Boat name in P&S superstructure	
19	固定式飞桥硬顶 带12块290w太阳能板	Fixed fly roof with 12x290w solar panels	

20	飞桥后甲板5块345w太阳能板，飞桥前甲板15块345w太阳能板	Aft 5x345w solar panels, fore 15x345w solar panels		
21	雷达架	Radar mast		硬顶之上
22	新西兰Fusion户外音响喇叭一对	Fusion outdoor speaker 1 pair		
23	飞桥屋顶LED天花灯 6个-316不锈钢外罩	6*sports lights for fly rooftop		
24	飞桥踢脚灯4只	4*courtesy lights for fly sofa		
	<b>3. Flybridge Helm 飞桥驾驶台</b>			
25	双人驾驶椅-面料为Sunbrella户外面料	Double helm seat		
26	仪表驾驶台	Instrument console		
27	不锈钢舵轮	Stainless steel steering wheel		
28	液压转向系统	Hydraulic power steering		
29	英国雷松12寸海图仪和甚高频	Raymarine 12"chart plotter and VHF		
30	电动机监控系统带独立显示器	Motor monitoring systems with display		
31	1个DC 12V 插座，1个AC 230V插座，1个USB插口 插座品牌：意大利VIMAR	1*DC 12V socket, 1*AC 230V socket, 1*USB		
	<b>4. Deck 甲板</b>			
32	316L不锈钢栏杆和扶手	Stainless steel guard rails and handrails		
33	316L不锈钢锚，重40KG，316L不锈钢锚链长50米+锚绳50米，直径10mm	Stainless steel anchor 40 kg with 50 m SS chain10 mm+rope 50M		
34	英国进口Lewmar电动锚机，1700w，	Electric anchor windlass, 1700W Lewmar		
35	船艏316L不锈钢锚链孔	Stainless steel hawse w/ roller on the bow		
36	316L不锈钢羊角8个	316L Stainless steel belaying cleats*8		
37	2个船尖防撞球储藏柜	2*Forepeak Stowage for fenders		
38	淡水注入口1个	Fresh water filler*1		
39	燃油注入口1个	Fuel fillers*1		
40	英国进口Lewmar左右一平式天窗	Port & Stbd flush hatch Lewmar		标配4只

41	2个船尖网	2* trampoline		
42	船艏锚机处监控摄像头1只	Camera on bow*1		
	<b>5. Aft Cockpit &amp; Stern area 后甲板和船艉区域</b>			
43	超大日光浴区	Large sunbathing area		
44	长沙发 和L型沙发, 面料Sunbrella品牌	Large settee & L shaped sofa		
45	白色玻璃钢面桌子1张 固定桌腿	White GRP table*1		
46	沙龙316L镜面不锈钢手动滑动门	Manual stainless steel sliding door to saloon		
47	前窗和侧窗带欧洲灰玻璃	Front & side windows with grey glass		
48	上建左舷的316L不锈钢滑动窗	Portside superstructure sliding window		
49	后甲板天花防水照明灯 11个 IP66	11*Aft ceiling lighting		
50	机舱入舱口	Access to engine room		
51	内置于游泳平台内的游泳梯	Bathing ladder integrated in bathing platform		
52	甲板冲洗系统接口	Connection for deck washing system		
	<b>6. Saloon Helm Console 沙龙驾驶台</b>			
53	双人驾驶椅-真皮皮料	Double helm seat		
54	意大利Osculati碳纤维舵轮	Carbon fiber steering wheel		
55	英国雷松导航系统	Raymarine navigation system		
56	电动机监控系统带独立显示器	Motor monitoring systems with display		
57	挡风屏雨刮器控制器	Control unit for windshield wiper		
58	锚机控制器	Control unit for anchor winch		
59	罗盘	Compass		
59	1个DC 12V 插座, 1个AC 230V 插座, 1个USB插口 插座品牌: 意大利VIMAR	1*DC 12V socket, 1*AC 230V socket, 1*USB		
	<b>Interior关于内装</b>			



60	全船采用E0级防水海洋板制作基础板以及家具	Waterproof Marine polywood for foundation board and furniture		
61	高档仿皮墙面，抗UV	High quality artificial leather, UV resistant		
62	沙发采用Sunbrella帆布布料（选配可升级皮料）	Sunbrella fabric for sofa		
63	家具使用科技木皮浅橡木色（选配可升级其他颜色）	Engineered wood veneer for furniture		
64	意大利SIRCA进口环保家具漆	Sirca Painting		
	<b><u>7. Salon沙龙</u></b>			
65	格力空调16000BTU*2	Air conditioning outlets		
66	L型沙发进口Sunbrella面料带抱枕	L-shaped sofa, with Sunbrella fabric , with cushions		
67	沙龙桌，带2个升降式桌腿	Table with two telescope support posts		
68	韩国LG地板	LG floor		
69	沙龙地板下有不锈钢油箱-1个1300L	Stainless steel fuel tanks under the salon floor—1*1300L		
70	沙龙地板下有电池组	Battery banks under the salon floor		
71	沙龙地板下有1个800L不锈钢水箱	Stainless steel water tanks under the salon floor—1 *800L		
72	天花板和墙面软包，PU仿皮	Ceiling and wall covering-PU leather		
73	左右下舱楼梯	Port & Stbd stairs		
74	升降电视（三星55寸）	Television w/ High-Low TV system (Samsung 55")		
75	LED天花灯15个，LED灯带	15* LED ceiling spot lights, LED light strip		
76	沙龙Fusion音响娱乐系统及一体式DVD播放器，含蓝牙、多区间技术以及两个扬声器-新西兰FUSION	Salon HIFI system with bluetooth, 2 speakers		
77	SIEMENS洗衣机5KG	SIEMENS Washing machine		
78	沙龙烟雾报警器	Smoke detector in salon		
79	1个DC 12V 插座，1个AC 230V插座 插座品牌：意大利VIMAR	1*DC 12V socket, 1*AC 230V socket		

<b>8. Galley厨房</b>			
80	可丽耐厨房台面	Corian countertops	
81	Siemens冰箱 500L	Siemens refrigerator / Freezer combination	Siemens或类似品牌
82	Siemens微波炉/烤箱一体机 45L	Microwave / Oven combination	Siemens或类似品牌
83	Siemens电磁炉	Ceramic hob	Siemens或类似品牌
84	Dometic抽油烟机	Extractor fan	
86	带冷热水的不锈钢洗菜盆	Stainless steel sink with cold/hot water	
87	韩国LG地板	LG floor	
88	抽屉柜	Drawer cabinet	
89	1个DC 12V 插座，1个AC 230V 插座，1个USB插口 插座品牌：意大利VIMAR	1*DC 12V socket, 1*AC 230V socket, 1*USB	
<b>9. Master Stateroom主人房</b>			
90	格力空调9000BTU	Air conditioning outlets	
91	双人床带床垫	Double berth with mattress	
92	床下有充裕的储物空间	Under-berth ample storage	
93	大衣柜，带抽屉	Large wardrobe with drawers	
94	抽屉柜	Drawer cabinets	
95	卫浴间滑动门	Door to en suite toilet and shower	
96	韩国LG地板	LG floor	
97	天花板和墙面软包，PU材料	Ceiling and wall covering-PU leather	
98	阅读灯2个	2*Reading lights	
99	天花灯 6个	6*Ceiling spot lights	
100	1个DC 12V 插座，1个AC 230V 插座，1个USB插口 插座品牌：意大利VIMAR	1*DC 12V socket, 1*AC 230V socket, 1*USB	
101	英国Lewmar天窗	Hatch	
<b>10. Owner's Bathroom 主人房卫浴间</b>			

102	独立式大淋浴室	Separate large shower		
103	高品质洗脸盆	High quality wash basin		
104	意大利Matro电动马桶及淡水水冲洗系统	Matro Electric toilet with freshwater flush system		
105	梳妆镜	Mirror		
106	天花灯2个	2*ceiling spot lights		
107	可丽耐盥洗台台面-白	Corian washstand top-white		
108	科勒洁具配件（水龙头，皂液盒，毛巾架和淋浴套件）	Kohler sanitary accessories (faucet, soap container, towel rack, and shower series)		
109	排气扇	Extractor fan		
110	1个AC 230V意大利VIMAR插座	1*AC 230V socket		
	<b>11. Stbd guest room右舷客房</b>			
111	格力空调5000BTU	Air conditioning outlets		
112	双人床带床垫，下方有充裕的储物空间	Double berth with matrss w/ ample stowage		
113	大衣柜	Ample wardrobe		
114	卫浴间入口	Access to bathroom		
115	甲板天窗	Deck hatch		
116	韩国LG地板	LG floor		
117	天花板和墙面软包，PU材料	Ceiling and wall covering-PU leather		
118	阅读灯2个	2*Reading lights		
119	天花灯 4个	4*Ceiling spot lights		
120	1个DC 12V 插座，1个AC 230V 插座，1个USB插口 插座品牌：意大利VIMAR	1*DC 12V socket, 1*AC 230V socket, 1*USB		
	<b>12. Stbd Bathroom 右舷卫浴间</b>			
121	独立淋浴间	Separate Shower		
122	高品质洗脸盆	High quality wash basin		
123	意大利Matro电动马桶及淡水水冲洗系统	Matro Electric toilet with freshwater flush system		

124	科勒洁具配件（水龙头，皂液盒，毛巾架和淋浴套件）	Kohler sanitary accessories (faucet, soap container, towel rack, and shower series)		
125	排气扇	Extractor fan		
126	1个AC 230V插座 插座品牌：意大利VIMAR	1*AC 230V socket		
127	天花灯5个	5*ceiling spot lights		
	<b>13. Port fore Cabin 左舷前客房</b>			
128	格力空调5000BTU	Air conditioning outlets		
129	双人床带床垫，下方有充裕的储物空间	Double berth with matrsss w/ ample stowage		
130	大衣柜	Ample wardrobe		
131	卫浴间入口	Access to bathroom		
132	韩国LG地板	LG floor		
133	天花板和墙面软包，PU材料	Ceiling and wall covering-PU leather		
134	阅读灯2个	2*Reading lights		
135	天花灯5个	5*ceiling spot lights		
136	1个DC 12V 插座，1个AC 230V插座，1个USB插口 插座品牌：意大利VIMAR	1*DC 12V socket, 1*AC 230V socket, 1*USB		
	<b>14. Port fore bathroom左舷前卫浴间</b>			
137	独立淋浴间	Separate Shower		
138	高品质洗脸盆	High quality wash basin		
139	意大利Matro电动马桶及淡水水冲洗系统	Matro Electric toilet with freshwater flush system		
140	梳妆镜	Mirror		
141	可丽耐盥洗台台面-白	Corian washstand top-white		
142	科勒洁具配件（水龙头，皂液盒，毛巾架和淋浴套件）	Kohler sanitary accessories (faucet, soap container, towel rack, and shower series)		
143	排气扇	Extractor fan		

144	1个AC 230VIMAR插座	1*AC 230V socket		
145	天花灯2个	2*ceiling spot lights		
	<b>15. Port Aft Cabin 左舷后客房</b>			
146	格力空调5000BTU	Air conditioning outlets		
147	双人床带床垫，下方有充裕的储物空间	Double berth with matrss w/ ample stowage		
148	大衣柜	Ample wardrobe		
149	卫浴间入口	Access to bathroom		
150	甲板天窗	Deck hatch		
151	韩国LG地板	LG floor		
152	天花灯5个	5*ceiling spot lights		
153	阅读灯2个	2*reading lights		
	<b>16. Port Aft bathroom左舷后卫浴间</b>			
154	独立淋浴间	Separate Shower		
155	高品质洗脸盆	High quality wash basin		
156	意大利Matro电动马桶及淡水水冲洗系统	Matro Electric toilet with freshwater flush system		
157	收妆镜	Mirror		
158	可丽耐盥洗台台面-白	Corian washstand top-white		
159	科勒洁具配件（水龙头，皂液盒，毛巾架和淋浴套件）	Kohler sanitary accessories (faucet, soap container, towel rack, and shower series)		
160	排气扇	Extractor fan		
161	1个AC 230VIMAR插座	1*AC 230V socket		
162	天花灯2个	2*ceiling spot lights		
	<b>17. Equipment Engine Room 机舱</b>			
162	船艉踏步机舱入口	Access to engine room through stern steps		
163	自动和手动 舱底泵 Jabsco品牌	Bilge pumps, automatic and manual		



164	自动紧急泵 -美国Jabaso	Flood pump, automatic		
165	机舱隔音系统	Engine room sound proof		
166	AC和DC照明灯2个	2*AC and DC Lights		
167	机舱灭火系统, 符合CE标准	Automatic fire extinguishing system according to CE		
168	燃油过滤系统, 带油水分离器	Fuel filter/clearing system with water separator		
169	1台450KW直流发电机	1*DC Generator 45KW		
170	2台50KW电动机	2* electric motors 50KW		
171	丹麦JEFA液压操舵系统	JEFA Hydraulic steering system		
172	热水器 60L 230V	1* water heater 60L 230V		
	<b>18. Electric &amp; Navigation System 电气/导航设备</b>			
173	1个岸电接口	1 Shore connections		
174	岸电接口和发电机 提供230V AC	AC 230 V provided by a shore and generator connection		
175	主配电板	Main electrical panels		
176	格力空调系统	Gree airconditioner		
177	160KWH锂电池包	Battery banks: 160KWH Li-battery 400V		
178	英国雷松18"雷达	Raymarine Quantum QD24D Doppler 18" Radar		
179	英国雷松Ray260甚高频	Raymarine Ray260 VHF		
180	2个英国雷松i70s多功能彩色显示器	2* Raymarine i70s Multifunction color display		
181	2个英国 雷松p70R自动驾驶控制器	2* Raymarine p70R Autopilot control head		
182	1个英国雷松AXIOM12寸多功能触摸显示器 1个英国雷松AXIOM12寸多功能触摸显示器 (带鱼探功能)	2*Raymarine AXIOM 12 multifunction 12" display		
183	1个英国雷松DST800测深测速测温传感器	1* Raymarine DTS800 through hull depth/ speed/ temperature smart transducer		
	<b>19. Underwater Gear水下设备</b>			
184	铜质P轴	Bronze P-brackets		

185	4叶螺旋桨	4-blade propeller		
186	铜质通海阀	Bronze sea cocks		
187	防腐蚀锌块	Zinc anodes		
188	防污漆	Antifouling		
	<b>20. Miscellaneous其他</b>			
189	6个柱型防撞球	6 cylinder fenders		
190	6根系泊缆绳, 每根20米	6 mooring rope 20 m ea.		
191	12人救生筏 以及ZC要求的其他救生装备 (救生圈、救生衣、烟火信号、消防桶、手提灭火器、号型标、示位标、雷达应答器等)	Liferaft for 12 persons, and other life saving equipment defined in Z		
192	船东手册	Owner's manual		
193	文件箱	Document box		
194	游艇文件	Yacht documentation		